

**owners
manual**

Model No.'s

**45-0194
45-0195**

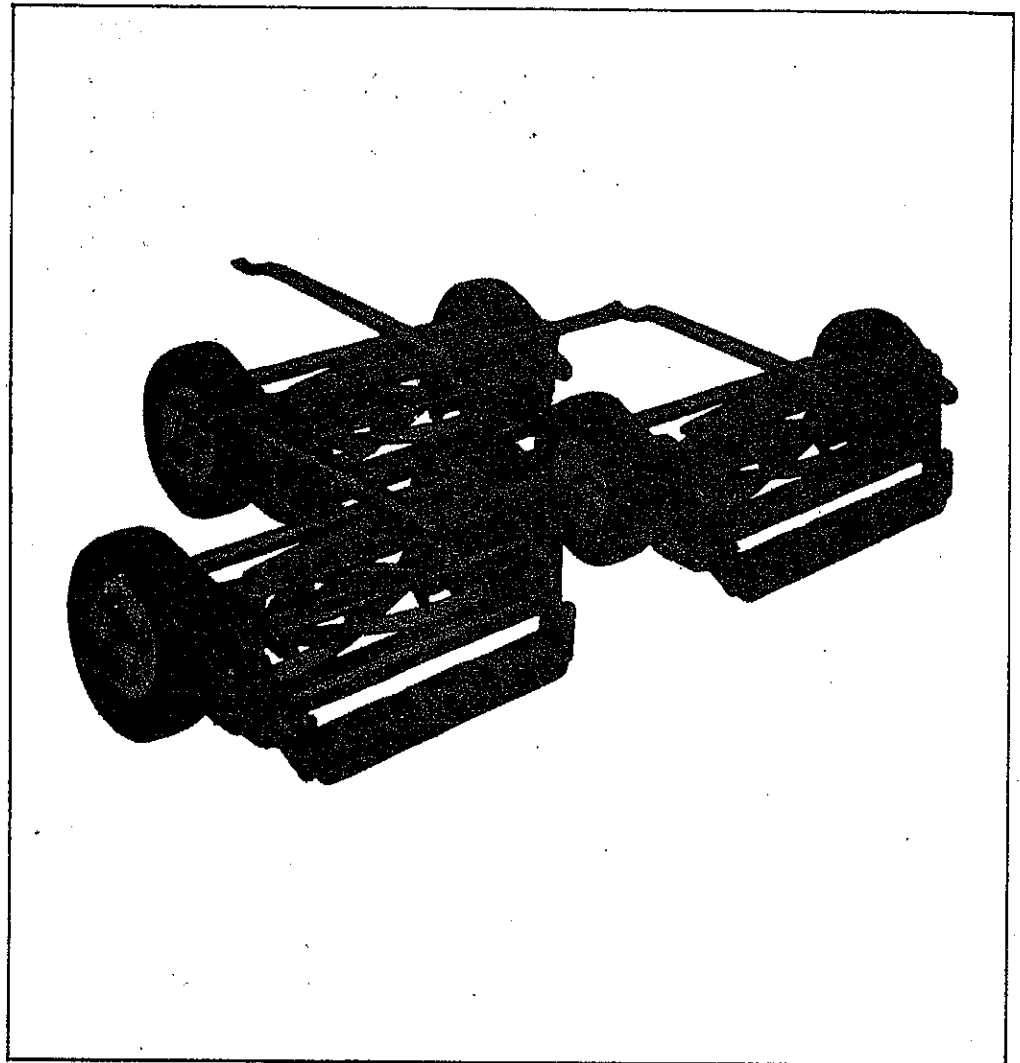

21" GANG REEL

**MODEL 45-0194—21" GANG SINGLE UNIT
MODEL 45-0195—21" GANG SET OF THREE (SHOWN)**

IMPORTANT:

**Read Rules for
Safe Operation
and Instructions
Carefully**

- **Assembly**
- **Operation**
- **Maintenance**
- **Repair Parts**

RULES FOR SAFE OPERATIONS

Remember, any power equipment can cause injury if operated improperly or if the user does not understand how to operate the equipment. Exercise caution at all times, when using power equipment.



LOOK FOR THIS SYMBOL TO POINT OUT IMPORTANT SAFETY PRECAUTIONS. IT MEANS — ATTENTION! BECOME ALERT. YOUR SAFETY IS INVOLVED.

1. Read the towing vehicle and gang reel manuals and know how to operate your vehicle, before using with gange reel attachment.
2. Do not allow children to operate the towing vehicle.
3. Do not allow adults to operate the towing vehicle without proper instruction.
4. Do not carry passengers, either on the towing vehicle or on the gang reel assemblies.
5. Keep children and pets a safe distance away.
6. Clear the work area of foreign objects.
7. Do not try to make any adjustments to the gang reels while unit is in motion.
8. Always begin with transmission in first (low) gear, and gradually increase speed as required.

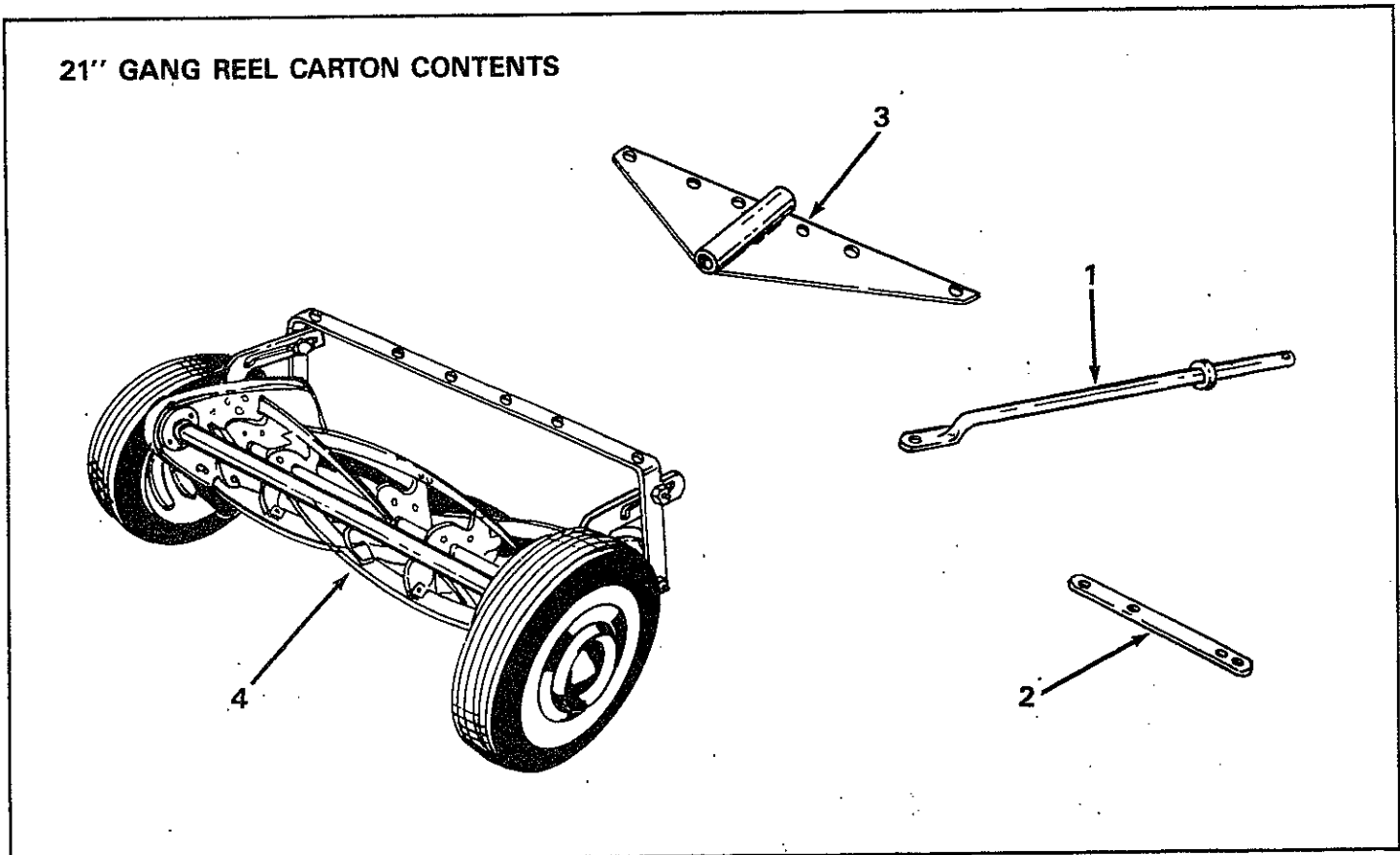

CARTON CONTENTS

Ref.	Qty.	DESCRIPTION	Ref.	Qty.	DESCRIPTION
1	1	Tow Bar Assembly	4	1	Reel Assembly Parts Package (Not Shown)
2	1	Outrigger Bar (Per Mower)		1	
3	1	Tow Bar Plate Assembly			

HITCH ASSEMBLY (TOW BAR)

1. Remove gang mower and loose parts from carton. Refer to carton contents figure on page 2 to correctly identify parts. Correct assembly of the two bar hitch is important in operating performance of the gang mowers.
2. Assemble tow bar plate to bridge bar using (6) 5/16-18 x 1" bolts and 5/16" hex lock nuts. See figure 1.
3. Insert tow bar through tow bar plate. Secure with washer, clevis pin and cotter. See figure 1.
4. Assemble clevis pin to tow bar using (2) spring cups, spring, bushing, washer and hairpin cotter. See figure 1.

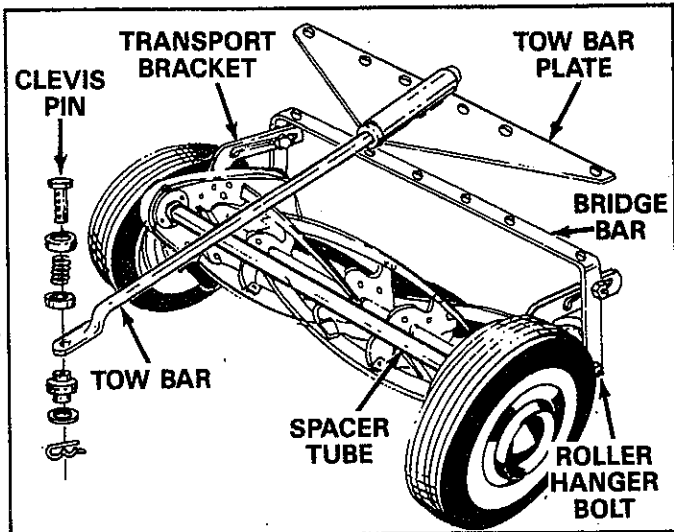

FIGURE 1

ADJUSTMENTS (HITCH ASSEMBLY)

1. Cutting height of the gang mower is adjustable from 5/8 to 2-1/4 inches. See instructions for changing adjustment from high to low cut.
2. The tow bar should be parallel to the ground for operation. The tow bar in this position is approximately 9 inches above the ground level. When tow bar is in inverted position, it is approximately 11 inches above the ground level.
3. Regardless of cutting height, tow bar should be parallel to the ground.

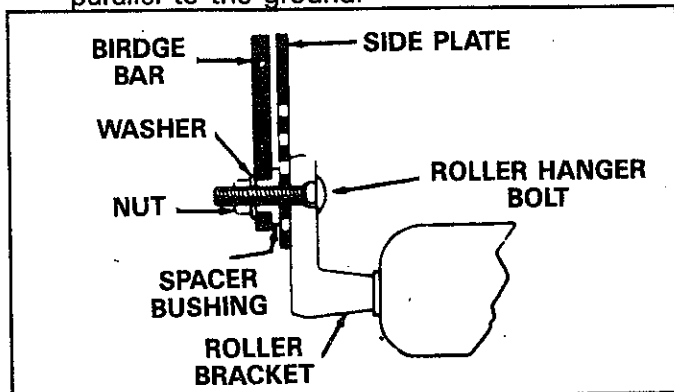

FIGURE 2

OPERATION



Do not carry passengers, either on the towing vehicle or on the gang reel assemblies.

The hitch for your gang mower has been designed to give dependable operating performance and flexibility under many lawn mowing conditions.

It is easily and quickly attached to your towing vehicle. The clevis pin and spring assembly provided with each hitch permits independent floating action so that the mower will follow the contour of the lawn. See figure 3.

Always begin with transmission in first (low gear, and gradually increase speed as required.

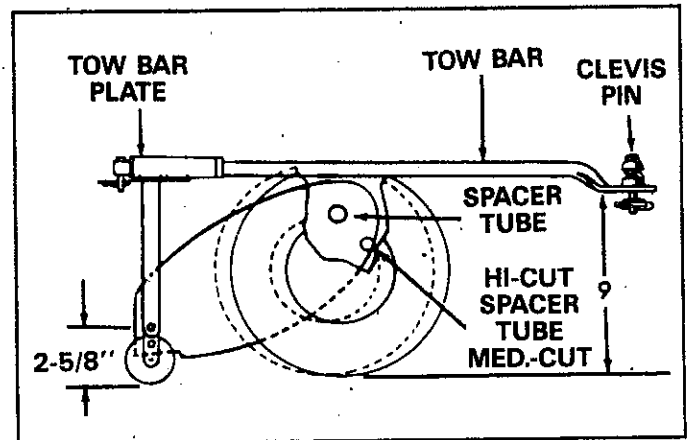

FIGURE 3

TRANSPORTING

Convenient transport brackets are provided for moving the gang mower from place to place without damage to reel or cutter bar.

To engage transport brackets, lift up on the front spacer tube to tilt mower back on rollers as far as possible. While holding mower in this position, lift up on ends of transport brackets to make certain that shoulder bolts in sides of bridge bar seat properly in notches at forward ends of bracket slots. Then release spacer tube. See figure 1.

The wheels, reel and cutter bar will remain suspended off the ground and mower will run on its rollers during transport.

To return mower to mowing position, lift up on front spacer tube and press downwards on ends of transport brackets.

ADJUSTMENTS (CUTTING HEIGHT)



Reel blades and cutter bar are very sharp. Use caution when making adjustments.

1. Loose axle nut approximately 3 turns. Disengage gear housing dowel from end plate by moving wheel and gear housing outward. Move wheel to desired setting. See figure 4.

HIGH CUT — 1-3/8 to 2-1/4 in.

Axle nut located in hole 1 and dimple in hole 4.

MEDIUM CUT — 3/4 to 1-3/8 in.

Axle nut located in hole 2 and dimple in hole 5.

LOW CUT — 5/8 to 1 in.

Axle nut located in hole 3 and dimple in hole 6.

2. Be sure dimple and shoulder nut seat in side plate holes.
3. Tighten axle nut securely.
4. Adjust roller to level chassis and attain desired height to cut.

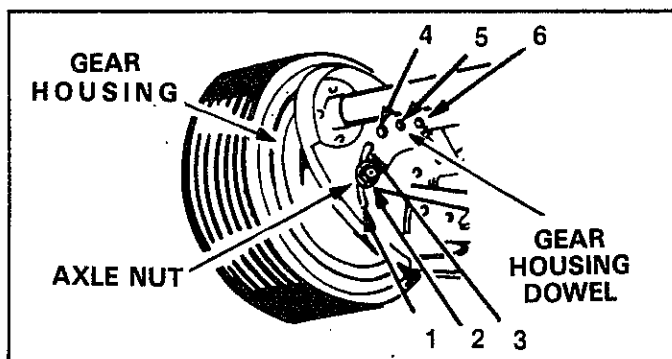

FIGURE 4

TO ADJUST ROLLER

1. Remove both roller hanger bolts.
2. Raise or lower roller to desired cut.
3. Set both sides of roller at same height, replace bolts and tighten.

PAPER TEST FOR REEL TO CUTTER BAR ADJUSTMENT

(See figure 5)

1. Insert strip of .003 thick bond paper approximately 2" wide between cutter bar and reel.
2. Turn reel slowly backward, with wheels off ground.
3. Adjust cutter bar so that reel blades pinch paper without cutting it.

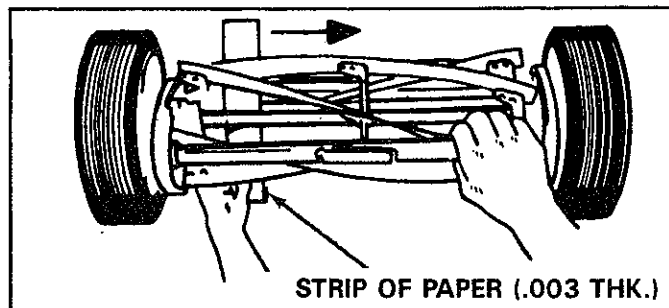

FIGURE 5
TO TIGHTEN CUTTER BAR ADJUSTMENT
(See figure 6)

1. Loosen top nut (Ref. 5) one quarter turn.
2. Tighten lower nut (Ref. 6).
3. Bolt (Ref. 7 and 8) must be tight after adjustment (both sides).

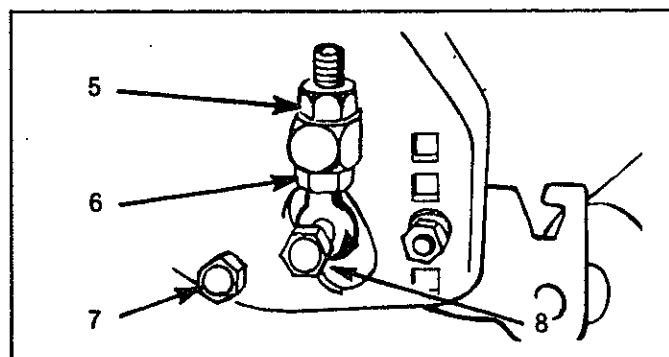

FIGURE 6
TO LOOSEN CUTTER BAR ADJUSTMENT
(See figure 6)

1. Loosen lower nut (Ref. 6) one quarter turn.
2. Tighten top nut (Ref. 5).
3. Bolts (Ref. 7 and 8) must be tight after adjustment (both sides).



NOTE

When cutter bar is removed for sharpening, left hand pivot bolt (Item 7), must be turned counterclockwise to be removed. Right hand pivot bolt must be turned clockwise.

LUBRICATION/MAINTENANCE

1. Seals on all bearings hold dirt out and grease in. No lubrication is required.
2. Oil roller shaft between the rollers once or twice a year so that rollers will roll freely.
3. If wheels are disassembled for repair, lubricate pinions with an all purpose automotive chassis grease.

SHARPENING

Sharpening is required when the mower will not cut satisfactory without the reel blades wiping on the cutter bar.

MODEL 45-0194

INSTRUCTIONS FOR ASSEMBLING THREE UNIT GANG

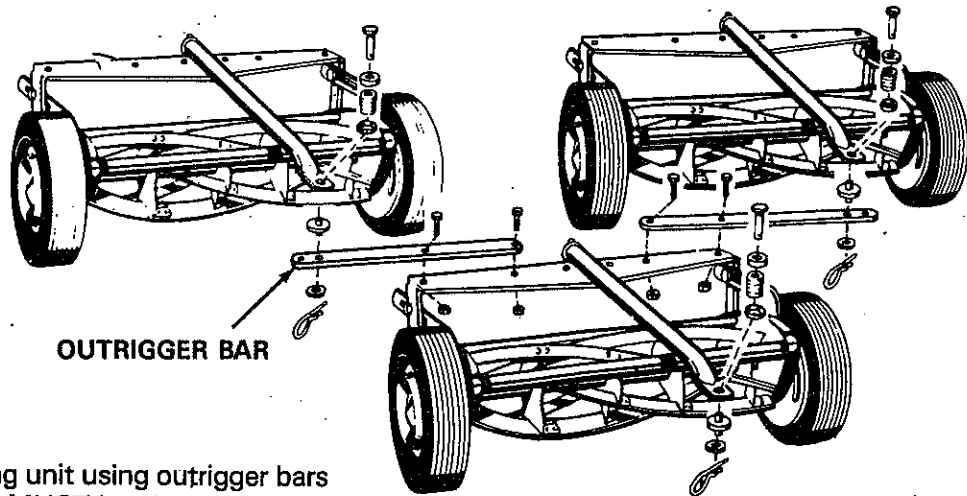

Assemble mowers into gang unit using outrigger bars as shown. Mounting bolts **MUST** be placed in holes indicated and nuts tightened securely.

OPTIONAL

INSTRUCTIONS FOR ASSEMBLING FIVE UNIT GANG

REQUIRES ONE MODEL 45-0195
AND TWO MODELS 45-0194

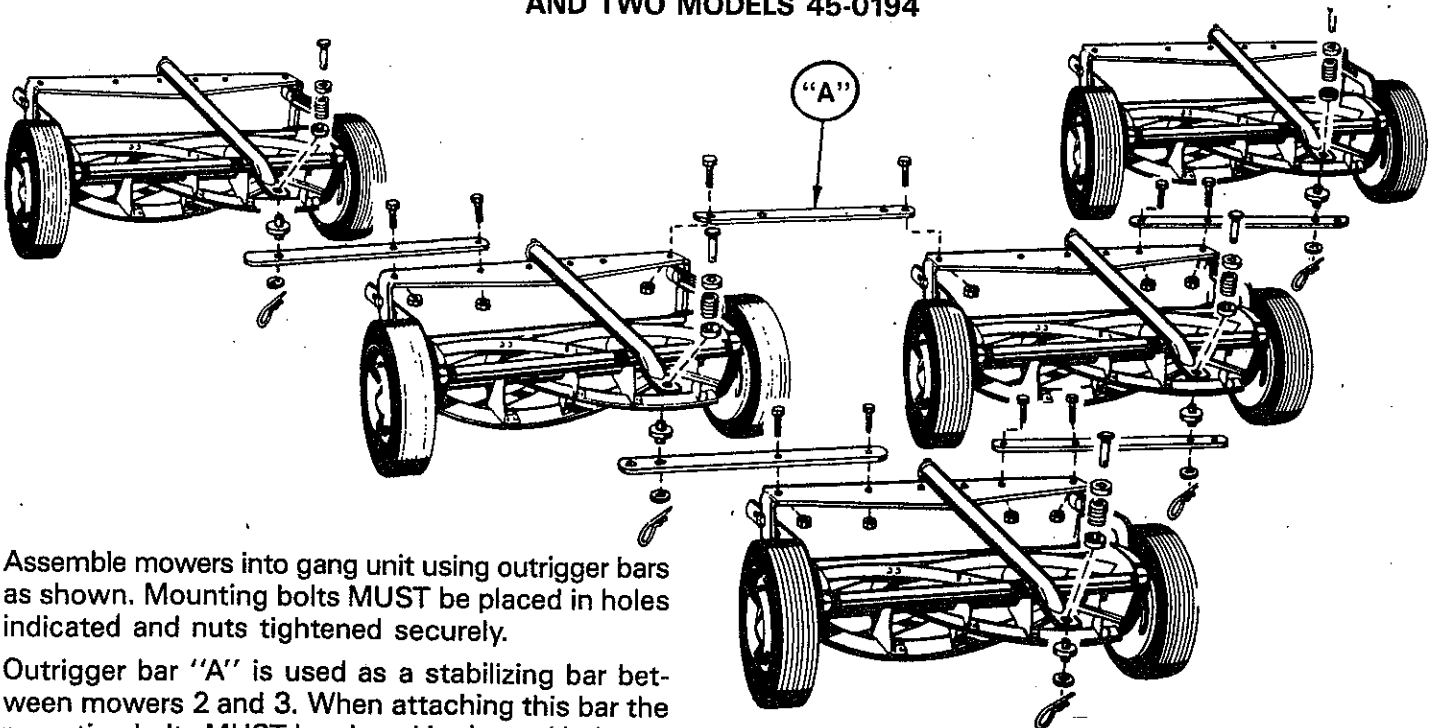

Assemble mowers into gang unit using outrigger bars as shown. Mounting bolts **MUST** be placed in holes indicated and nuts tightened securely.

Outrigger bar "A" is used as a stabilizing bar between mowers 2 and 3. When attaching this bar the mounting bolts **MUST** be placed in the end holes as shown. Tighten nuts securely then loosen each nut one full turn to permit bar to pivot.

MODEL 45-0194 21" SINGLE GANG REEL

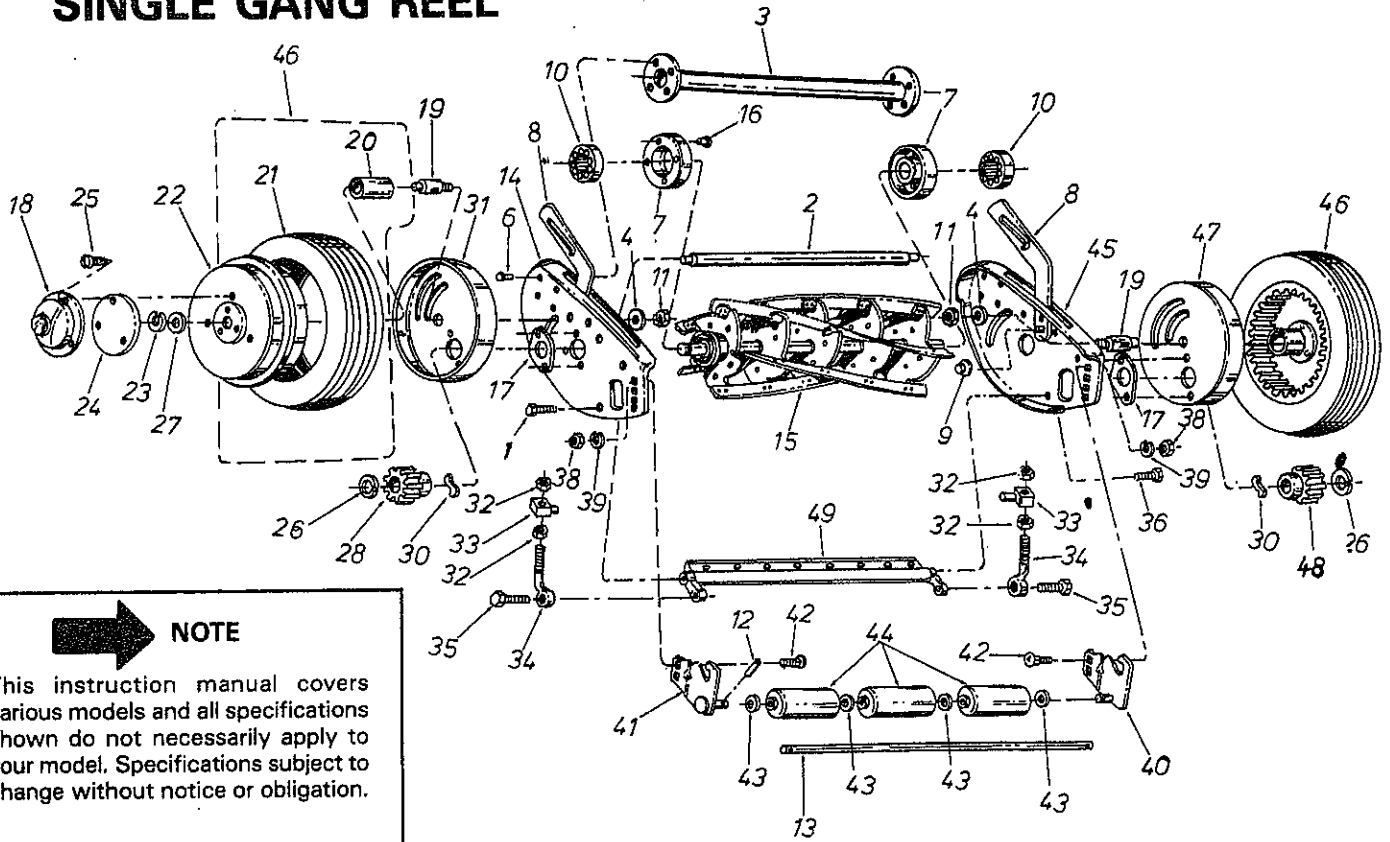

NOTE

This instruction manual covers various models and all specifications shown do not necessarily apply to your model. Specifications subject to change without notice or obligation.

REPAIR PARTS LIST FOR MODEL 45-0194 GANG REEL

REF. NO.	PART NO.	QTY.	DESCRIPTION	REF. NO.	PART NO.	QTY.	DESCRIPTION
1	1509-086	1	Screw Front L.H. Thd.	25	1511-029	6	Scr. #10-32 x 1-3/8 Thd. Cutting
2	2624-110	1	Spacer End Plate	26	1650-021	2	Retaining Ring*
3	1112-015	1	Spacer Tube Ass'y.	27	1540-118	2	Washer
4	1657-19	2	Step Bushing	28	0428-000	1	Pinion Gear - L.H.
6	44060	8	Rivet 3/16 x 3/8 PLTD	30	0323-000	1	Pawl
7	1629-028	3	Retainer	31	1118-014	1	Gearing Housing - L.H.
8	2609-217	2	Transport Brkt.	32	0052-000	4	Hex Nut 3/8-24 Semi Fin*
9	44166	2	Nut-1/2" Cap Push	33	0011-000	2	Trunnion
10	44232	2	Bearing	34	0451-000	2	Cutter Bar Adjusting Bolt
11	44738	2	Nut - 5/16-24 Hex Lock	35	0453-000	2	Screw - Rear
12	1548-007	1	Roll Pin	36	0455-000	1	Screw - Front R.H. Thd.
13	1632-084	1	Roller Shaft	38	43083	2	Hex Nut 5/16-18*
14	1129-180	1	End Plate with Trunnions - L.H.	39	43086	2	L-Wash. 5/16" I.D.*
15	3135-036	1	Reel Ass'y. - 21"	40	2132-045	1	Roller Brkt. - R.H.
16	9-0	6	Rivet 3/16 x 13/32 Rd. Hd.*	41	2132-044	1	Roller Brkt. - L.H.
17	1629-009	3	Bearing Retainer	42	43079	2	Carr. Bolt 5/16-18 x 1*
18	2674-027	2	Hub Cap	43	R19171616	4	Washer 17/32 x 1" x 16 Ga.
19	1631-051	2	Axle	44	1658-012	3	Roller - 3 Required
20	1652-052	1	Bearing	45	1129-181	1	End Plate with Trunnions - R.H.
21	2619-034	2	Tire	46	1108-095	2	Drive Wheel Ass'y. w/tire
22	1110-030	2	Drive Wheel - Less Tire	47	1118-013	1	Gear Housing - R.H.
23	1650-001	2	Retaining Ring	48	0425-000	1	Pinion Gear - R.H.
24	2718-003	2	Wheel Weight	49	3134-024	1	Cutter Bar Ass'y.

*Purchase Common Hardware Locally

MODEL 45-0194 — 21" SINGLE GANG REEL

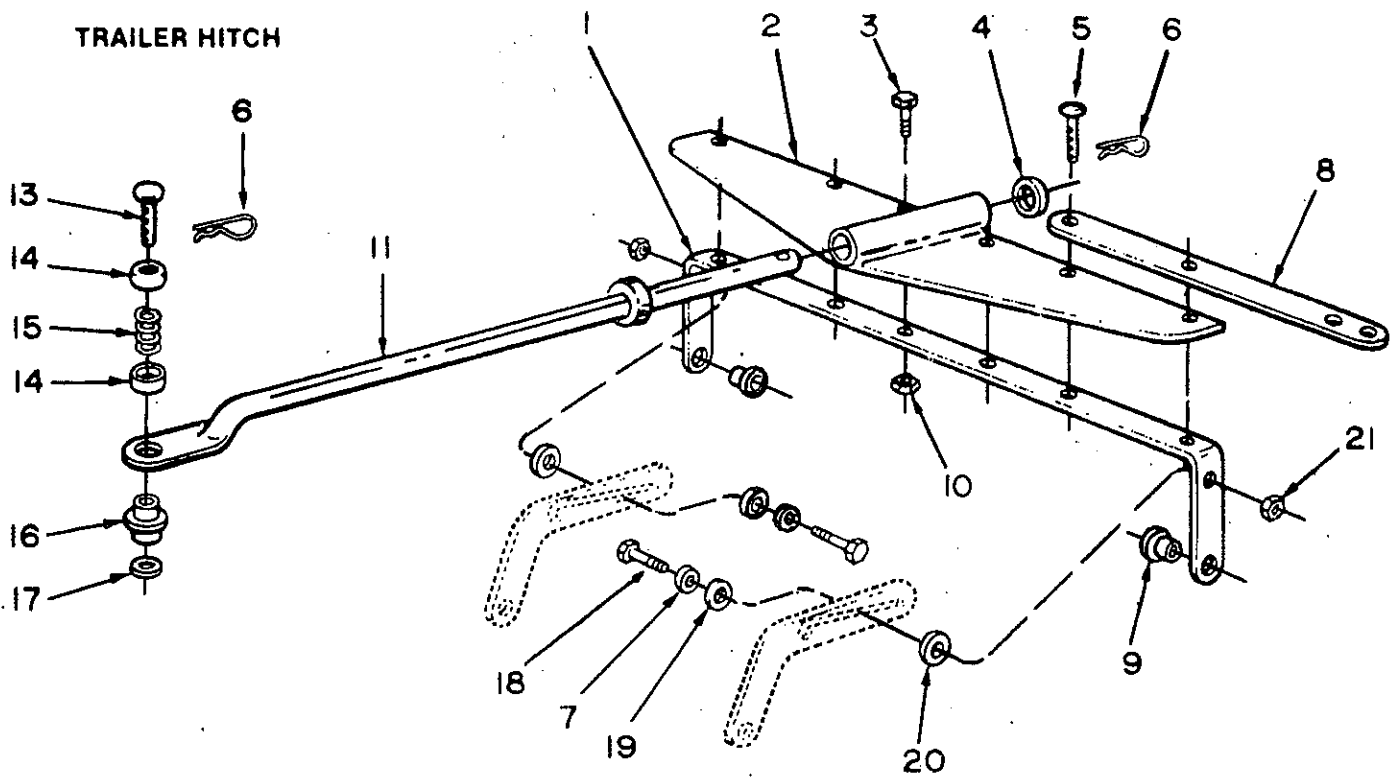

REPAIR PARTS LIST FOR HITCH (TWO BAR)

REF. NO.	PART NO.	QTY.	DESCRIPTION
1	3698-003	1	Bridge
2	3111-068	1	Tow Bar Plate Ass'y.
3	43063	6	Bolt 5/16 x 18 x 1*
4	1540-058	1	Washer
5	0041-042	1	Clevis Pin Spec.
6	43055	2	Hairpin Cotter, 3/32"
7	1552-008	2	Washer - Special
8	1697-005	1	Outrigger Bar
9	1657-005	2	Spacer Bushing
10	43064	6	Hex Lock Nut 5/16-18
11	3125-006	1	Tow Bar Ass'y.
13	1545-008	1	Clevis Pin
14	0041-035	2	Spring Cup
15	0041-036	1	Spring
16	1657-016	1	Bushing
17	43081	1	Washer 11/32 x 7/8*
18	1513-45	2	Shoulder Bolt
19	0141-000	2	Washer
20	1624-135	2	Spacer
21	43013	2	Hex L-Nut 1/4-20*
	44065	1	Owner's Manual

*Purchase Common Hardware Locally.