

MASCOT

21" Gang Reel Mower OWNERS MANUAL

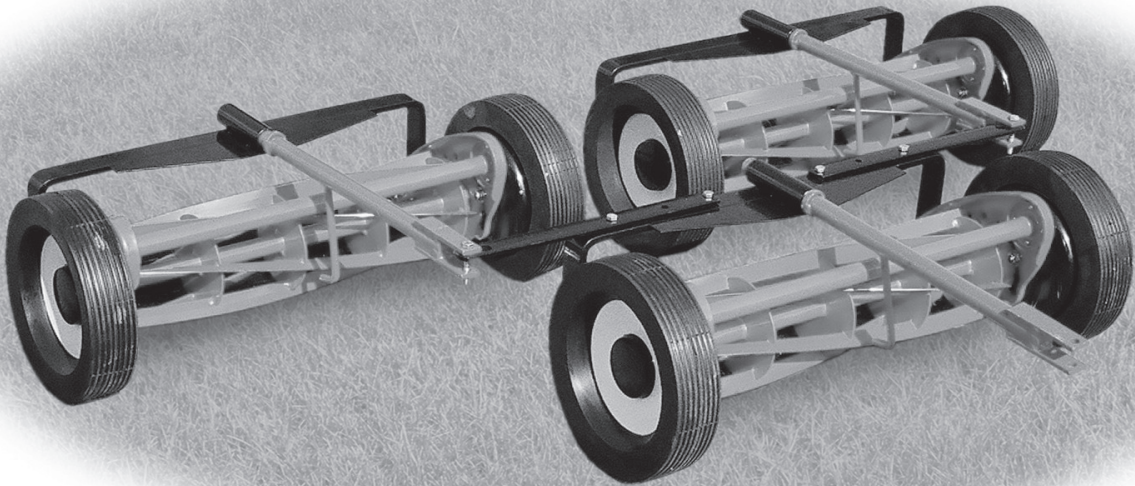

MODEL 358

Set of 3 Mowers

MODEL 5-96

Set of 5 Mowers

Also the mower units for:

MODEL F-358

MODEL F-592

MODEL F-7-130"

Tri-Wheel Deluxe

IMPORTANT:

Read all instructions
carefully before assembling
and using this product.

For Repair Parts Call:

Mascot Sharpening & Sales
434-B Newport Road
Ronks, PA 17572
717-656-6486

Rules For Safe Operations

Remember, any power equipment can cause injury if operated improperly or if the user does not understand how to operate the equipment. Exercise caution at all times, when using power equipment.



LOOK FOR THIS SYMBOL TO POINT OUT IMPORTANT SAFETY PRECAUTIONS. IT MEANS — ATTENTION! BECOME ALERT. YOUR SAFETY IS INVOLVED.

1. Read the towing vehicle and gang reel manuals and know how to operate your vehicle, before using with gang reel attachment.
2. Do not allow children to operate the towing vehicle.
3. Do not allow adults to operate the towing vehicle without proper instruction.
4. Do not carry passengers, either on the towing vehicle or on the gang reel assemblies.
5. Keep children and pets a safe distance away.
6. Clear the work area of foreign objects.
7. Do not try to make any adjustments to the gang reels while unit is in motion.
8. Always begin with transmission in first row (low) gear, and gradually increase speed as required.

21" GANG REEL CARTON CONTENTS

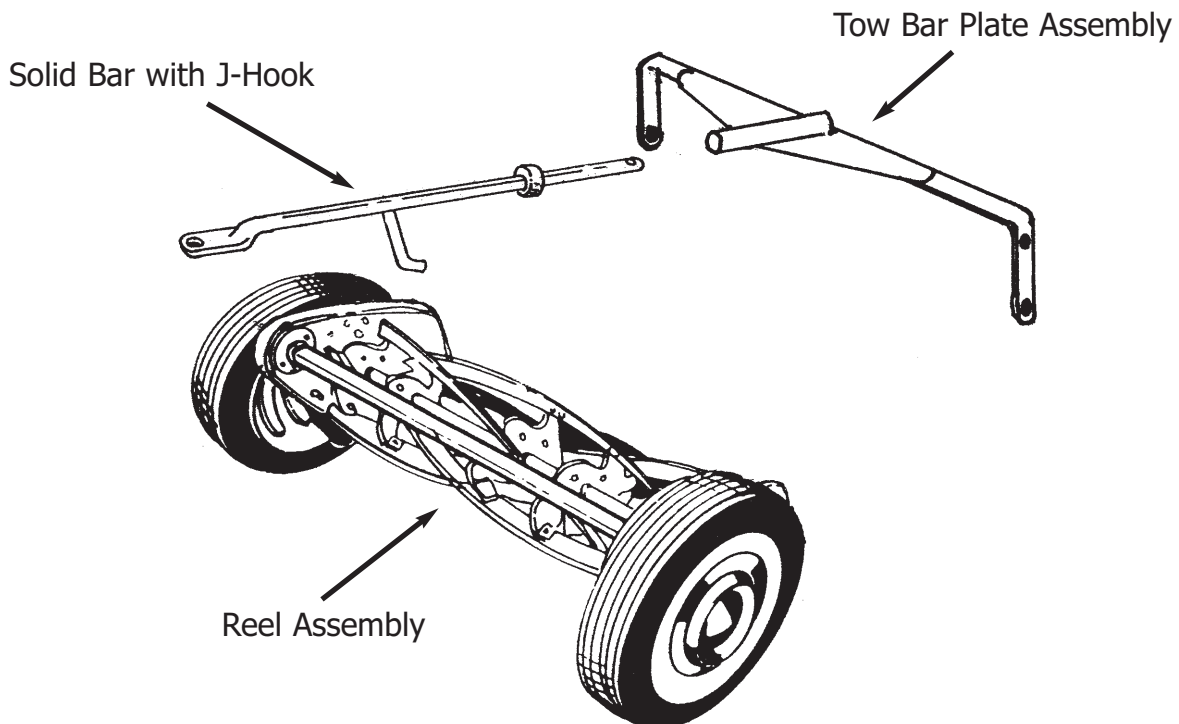

Hitch Assembly (Tow Bar)

Remove gang mower and loose parts from carton. Refer to carton contents figure on page 2 to correctly identify parts. Correct assembly of the two bar hitch is important in operating performance of the gang mowers.

Adjustments (Hitch Assembly)

1. Cutting height of the gang mower is adjustable from 5/8 to 3 inches. See instructions for changing adjustment from high to low cut.
2. The tow bar should be parallel to the ground for operation. The tow bar in this position is approximately 9 inches above the ground level. When tow bar is in inverted position, it is approximately 11 inches above the ground level.
3. Regardless of cutting height, tow bar should be parallel to the ground.

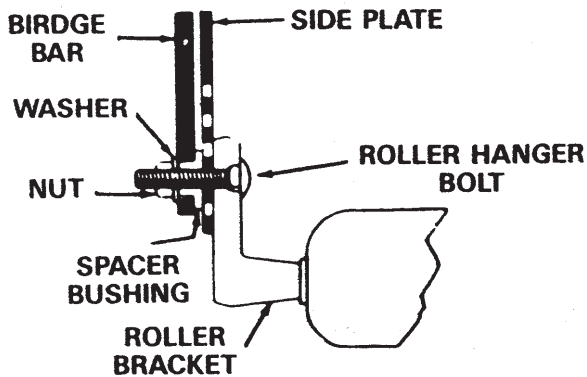



Figure 2

Model #45-0194

Cut Height in Inches	Roller Setting	Wheel Setting
1	2	4
1 1/4	5	3
1 1/2	3	3
1 3/4	1	3
2	4	2
2 1/4	3	2
2 1/2	2	2
2 3/4	3	1
3	1	1

Operation



Do not carry passengers, either on the towing vehicle or on the gang reel assemblies.

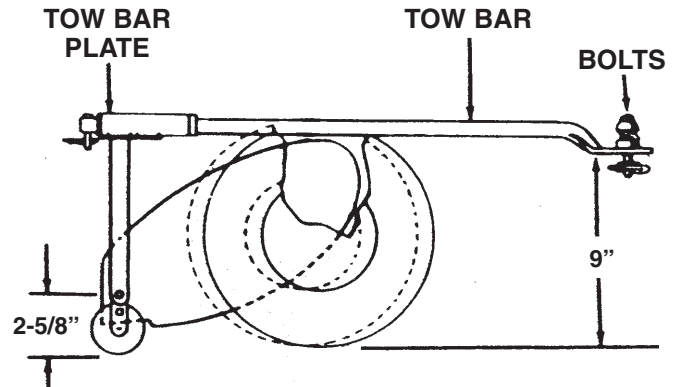

Figure 3

The hitch for your gang mower has been designed to give dependable operating performance and flexibility under many lawn mowing conditions.

It is easily and quickly attached to your towing vehicle. The clevis pin and spring assembly provided with each hitch permits independent floating action so that the mower will follow the contour of the lawn. See figure 3.

Always begin with transmission in first (low gear, and gradually increase speed as required.

Adjustments (Hitch Assembly)

1. Loosen axle nut approximately 3 turns.
Disengage gear housing dowel from end plate by moving wheel and gear housing outward. Move wheel to desired setting. See figure 6
2. Be sure dimple and shoulder nut seat in side plate holes.
3. Tighten axle nut security.
4. Adjust to level chassis and attain desired height to cut.

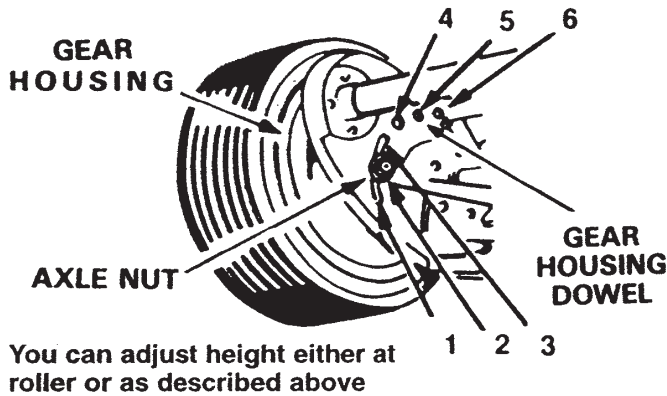

See Chart on Page 3

TO ADJUST ROLLER

1. Remove both roller hanger bolts.
2. Raise or lower to desired cut.
3. Set both sides of roller at same height, replace bolts and tighten.

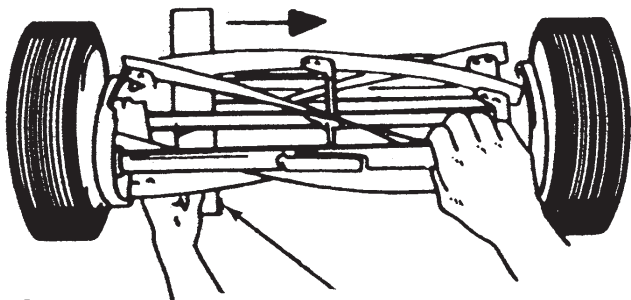

Figure 5 STRIP OF PAPER (.003 THK.)

PAPER TEST FOR REEL TO CUTTER BAR ADJUSTMENT

(See figure 5)

1. Insert strip of .003 thick bond paper approximately 2" wide between cutter bar and reel.
2. Turn reel slowly backward, with wheels off ground.
3. Adjust cutter bar so that reel blades pinch paper without cutting it.

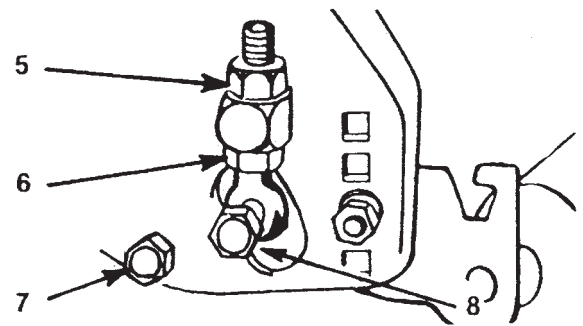

Figure 6

TO TIGHTEN CUTTER BAR ADJUSTMENT

(See figure 6)

1. Loosen top nut (Ref. 5) one quarter turn.
2. Tighten lower nut (Ref. 6)
3. Bolt (Ref. 7 and 8) must be tight after adjustment (both sides)

TO LOOSEN CUTTER BAR ADJUSTMENT

(See figure 6)

1. Loosen lower nut (Ref. 6) one quarter turn.
2. Tighten top nut (Ref. 5)
3. Bolts (Ref. 7 and 8) must be tight after adjustment (both sides)

Lubrication/Maintenance

1. Seals on all bearings hold dirt out and grease in. No lubrication is required.
2. Oil roller shaft between the rollers once or twice a year so that rolls will roll freely.
3. If wheels are disassembled for repair, lubricate pinions with an all purpose automotive chassis grease.

NOTE

When cutter bar is removed for sharpening, left hand pivot bolt (Item 7), must be turned counterclockwise to be removed. Right hand pivot bolt must be turned clockwise.

Sharpening

Sharpening is required when the mower will not cut satisfactory without the reel blades wiping on the cutter bar.

Model 358

INSTRUCTIONS FOR ASSEMBLING THREE UNIT GANG

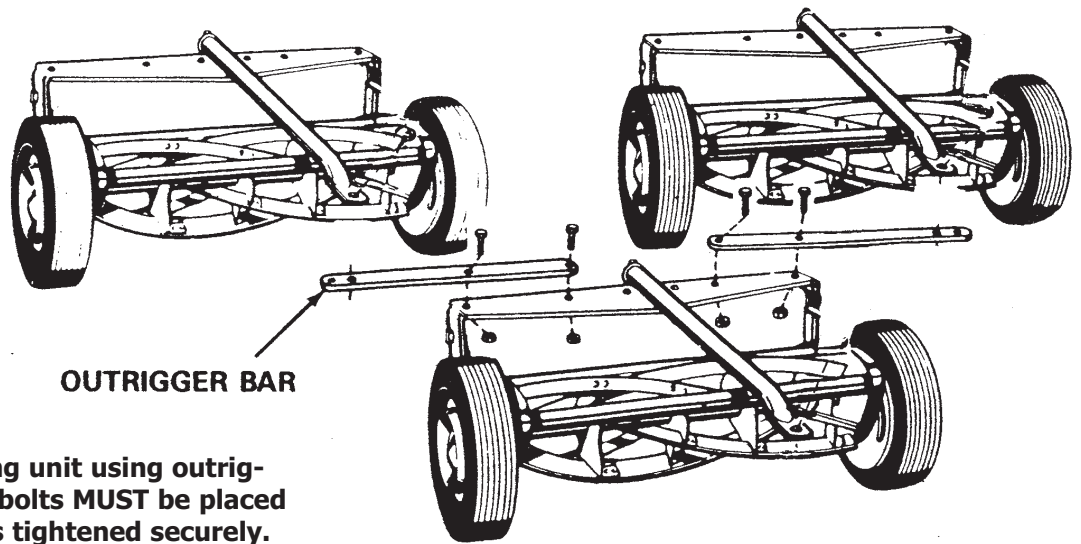

Assemble mowers into gang unit using outrigger bars as shown. Mount bolts **MUST** be placed in holes indicated and nuts tightened securely.

Model 5-96

INSTRUCTIONS FOR ASSEMBLING

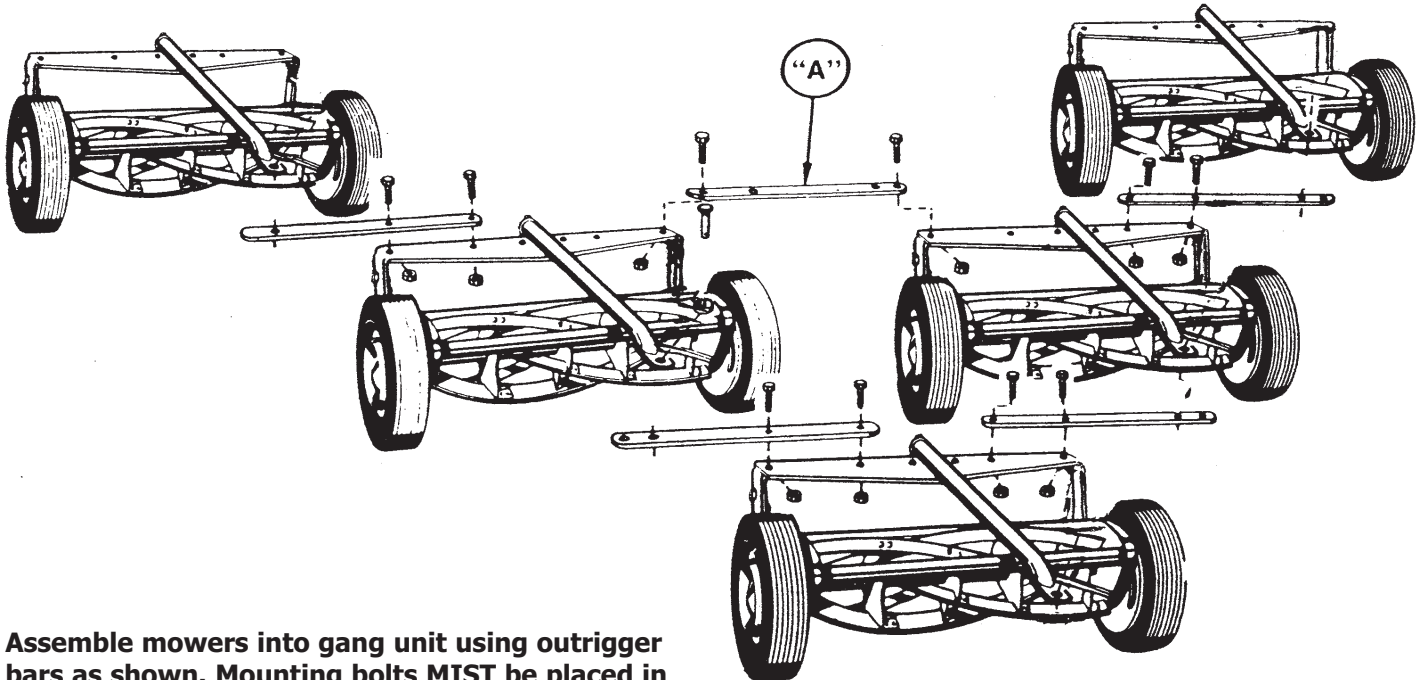

Assemble mowers into gang unit using outrigger bars as shown. Mounting bolts **MUST** be placed in holes indicated and nuts tightened securely. Outrigger bar "A" is used as a stabilizing bar between mowers 2 and 3. When attaching this bar the mounting bolts **MUST** be placed in the end holes as shown. Tighten nuts securely then loosen each nut one full turn to permit bar to pivot.

Model 45-0194

21" Single Gang Reel

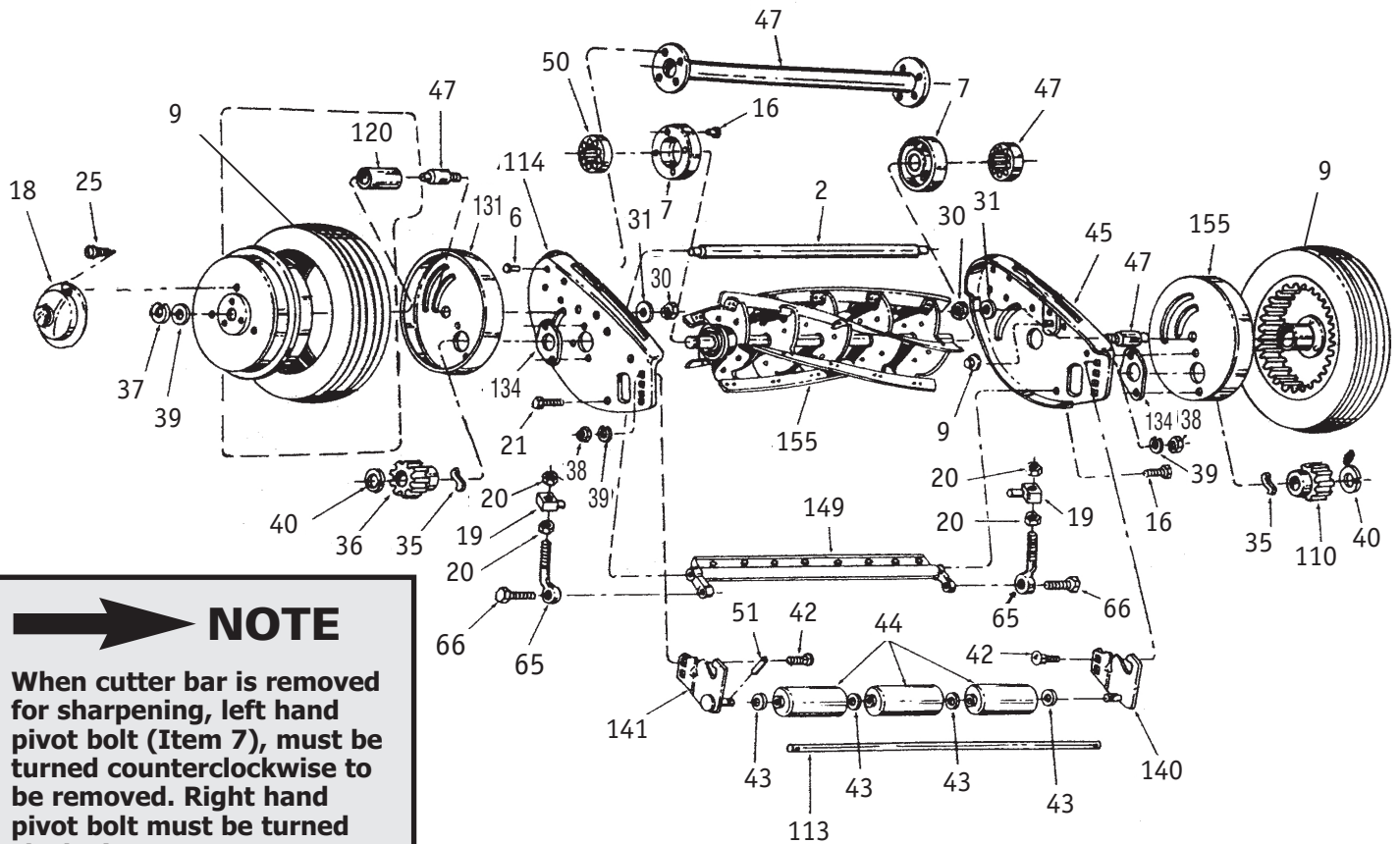

NOTE

When cutter bar is removed for sharpening, left hand pivot bolt (Item 7), must be turned counterclockwise to be removed. Right hand pivot bolt must be turned clockwise.

REPAIR PARTS FOR MODEL NO. 45-0194 21" GANG REEL MOWER

REF. NO.	PART NO.	QTY.	DESCRIPTION	REF. NO.	PART NO.	QTY.	DESCRIPTION
2	2624-110	1	Spacer End Plate	45	1129-181	1	End Plate R.H. - 21" gang only
6	44060	8	Rivet 3/16 x 3/8 PLTD	47	1631-51	2	Axle
16	1509-086	1	Screw Front L.H. Thd.	50	44232	2	Bearing
19	46324	2	Trunnion for Adjustment Screw	51	1548-007	1	Roller Shaft Pin
21	0455-000	1	Cutter Screw R.H.	53	1629-028	3	Retainer
9	1108-95	2	Drive Wheel Assembly	65	0451-000	2	Cutter Bar Adjusting Bolt
25	1511-029	6	Scr. #10-32 x 1-3/8 Thread Cutting	66	0453-000	2	Screw - rear
29	1112-015	1	Spacer Tube Assembly - for 21"	110	0425-000	1	Pinion Gear R.H.
30	44738	2	Nut - 5/16-24 Hex Lock	113	1632-084	1	Roller Shaft - gang and 21" push
31	1657-019	2	2 Piece Washer Bushing	114	1129-180	1	End Plate L.H. - 21"
32	1118-013	1	Gear Housing R.H.	120	1652-052	1	Old Style Bronze Bearing
35	0323-000	1	Pawl	131	1118-014	1	Gear Housing L.H.
36	0428-000	1	Pinion Gear L.H.	134	1629-009	3	Bearing Retainer
37	1650-001	2	Retaining Ring	140	2132-045	1	Roller Bracket R.H.
40	1650-021	2	Retaining Ring *	141	2132-044	1	Roller Bracket L.H.
41	2674-033	2	Hub Cap	149	3134-024	1	Cutter Bar Assembly - 21"
42	43079	2	Carriage Bolt 5/16-18 x 1 *	155	3135-036	1	Reel Assembly - 21"
44	1658-012	3	Roller, each section - 3 required	156			Operators Manual

* Purchase Common Hardware Locally.

MODEL 45-0194 21" SINGLE GANG REEL

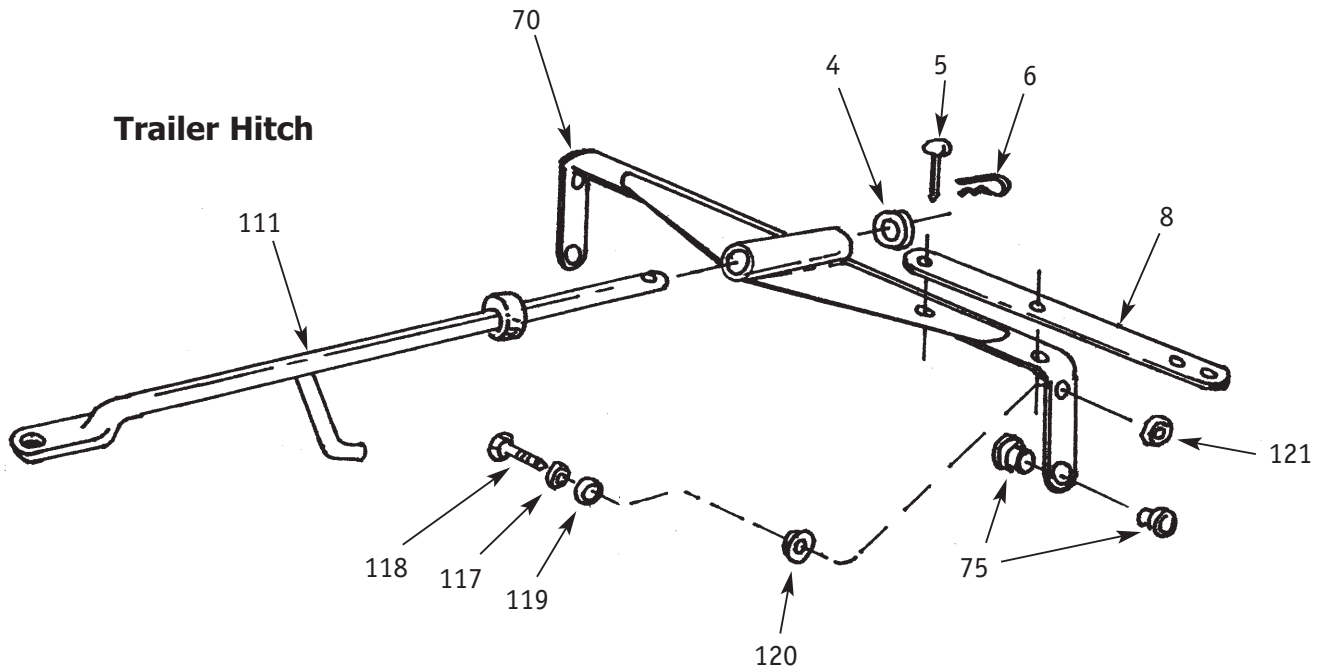

REPAIR PARTS LIST FOR HITCH (TWO BAR)

REF. NO.	PART NO.	QTY.	DESCRIPTION
3	43063	6	Bolt 5/16 x 18 x 1" *
4	1540-058	1	Washer
5	0041-042	1	Clevis Pin
6	43055	1	Hairpin Cotter
8	1697-005	1	Outrigger Bar
10	43064	6	Hex Lock Nut 5/16-18
69	2830		Old Style Tube Hitch - no J Hook
70	3600	1	Bridge and Tow Bar Plate Assembly - new style is welded together
75	3000	4	2 Step Bushings - on each side for bracket
111	2820	1	Tow Bar Assembly - solid shaft with J Hook
117	43081	1	Washer 11/32 x 7/8 *
118	1513-45	2	Shoulder Bolt
119	0141-000	2	Washer
120	1624-135	2	Spacer
121	43013	2	Hex L-Nut 1/4-20 *
156		1	Owners Manual

* Purchase Common Hardware Locally.

**For Repair Parts Call
Mascot Sharpening & Sales**

434-B Newport Road
Ronks, PA 17572

717-656-6486